

MCT

Multi-Compression Tools

Instruction Sheet



Smartly Designed with Technicians in Mind

Each MCT tool comprises a frame, release trigger, lever, storage compartment, wrench and gauge, plunger, and connector support wheel. (Fig. MCT-1)

The connector support wheel has two sets of dogs. Color-coded indicators on the wheel front identify the correct dogs for the application. (Fig. MCT-2)

MCT-101 wheels are yellow and blue; MCT-102 wheels are yellow and red. Each is imprinted with a helpful arrow which indicates spin direction. Plungers are factory-calibrated to support all connectors in a class.

MCT-101 multi-compression tools attach all RCA and F connectors used on RG-6, 59, and 11 cables.

MCT-102 multi-compression tools attach all RCA, F and BNC connectors used on RG-6, 59, and mini-coax cables.

The MCT Advantage

- Factory calibration ensures accurate attachment.
- Spin-and-store wheel simplifies operation.
- Easy-release dogs enable one-handed operation.
- High mechanical advantage facilitates attaching difficult connectors.
- 360-degree connector support ensures uniform compression.
- Balanced, lightweight design allows operation with either hand.

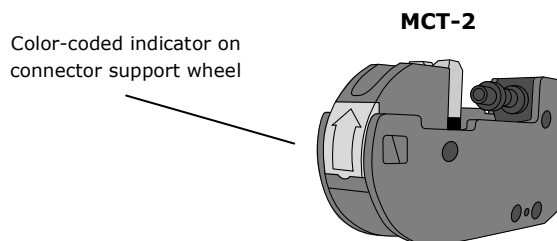
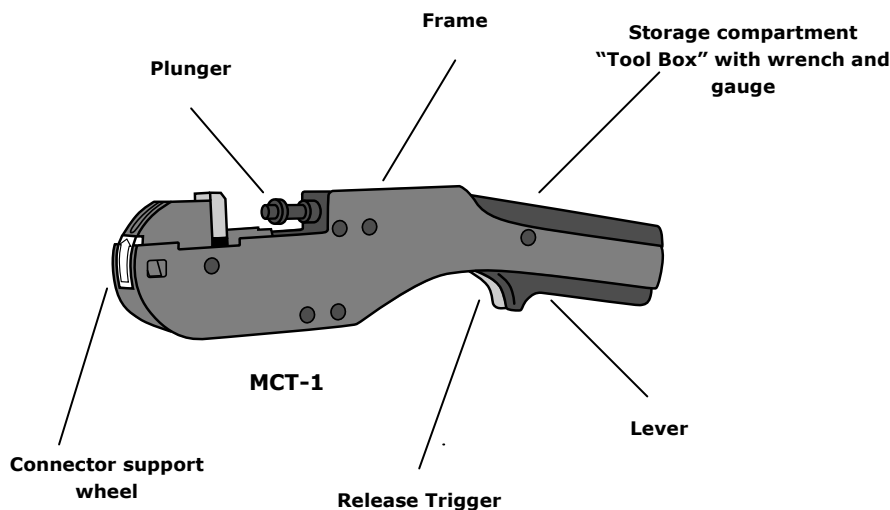

For online instruction videos and order information, visit www.CablePrep.com.

For technical assistance and distributor information, contact Cable Prep.

MCT Multi-Compression Tools Instruction Sheet

How to Use MCT Tools

FIRST

Square cut cable with Cable Prep brand cable cutters. Remove jacket, cut braid and dielectric, and expose center conductor with correct CPT tool. [Fig. MCT-3]

1. Fold braid back over jacket. [Fig. MCT-4]
2. If using Wind Ding torque wrench, install it on connector. [Fig. MCT-5]
3. Slide connector onto cable until dielectric is flush with connector's internal mandrel and correct length of center conductor is exposed. [Fig. MCT-6]
4. Open MCT lever by depressing trigger. [Fig. MCT-7]
5. Rotate MCT wheel until correct dogs are in position. [Fig. MCT-8] Seat the spring-loaded wheel stops properly by rotating wheel slightly past position and then back to position.
6. Align connector and cable along tool, and place open end of connector on plunger tip. [Fig. MCT-9]
7. For RCA connectors, insert connector tip into slot at top of plunger. [Fig. MCT-10]
8. Push cable into support dogs. [Fig. MCT-11]
9. Squeeze lever to secure connector. [Fig. MCT-12]
10. Depress trigger to open lever and remove cable and connector from tool. [Fig. MCT-13]
11. Squeeze lever to close and lock it for storage. [Fig. MCT-14]

The connector is now properly attached to the cable.

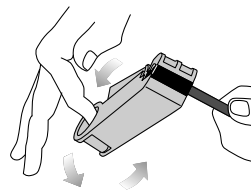

MCT-3

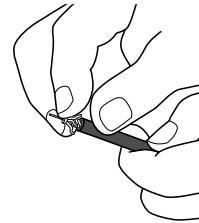

MCT-4

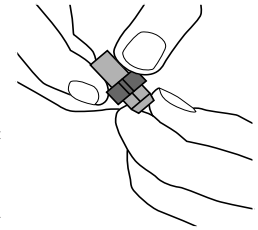

MCT-5

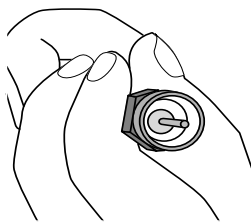

MCT-6

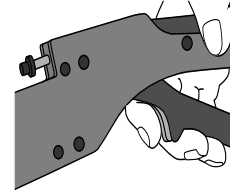

MCT-7

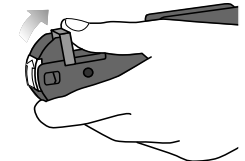

MCT-8

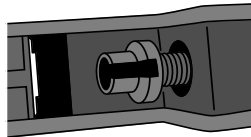

MCT-9

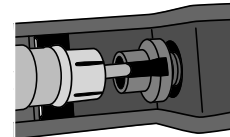

MCT-10

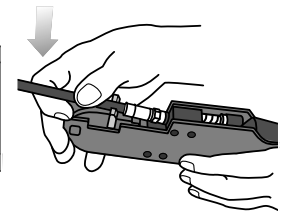

MCT-11

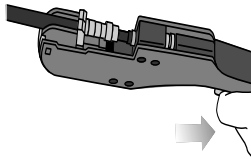

MCT-12

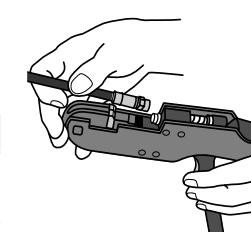

MCT-13

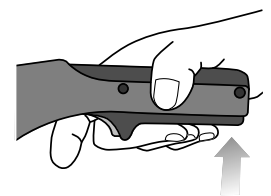

MCT-14

MCT Multi-Compression Tools Instruction Sheet

How to Maintain MCT Tools

About Factory Calibration

MCT tools are factory-calibrated for specific connector throw distances. A lock nut on the plunger maintains calibration for long periods of use.

To recalibrate **MCT-101** Tools:

1. Remove wrench from storage compartment, labeled "Tool Box". [Fig. MCT-M1]
2. Loosen lock nut on plunger. [Fig. MCT-M2]
3. Open lever by depressing trigger. [Fig. MCT-M3]
4. Rotate wheel to blue position. Seat spring-loaded wheel stops properly by rotating wheel slightly past position and then back to position. [Fig. MCT-M4]
5. Use wrench as a gauge by positioning it horizontally between support dogs and plunger tip. Place legs of wrench against support dogs and flat end of gauge across plunger tip. [Fig. MCT-M5]
6. Close lever while rotating plunger until it touches flat end of gauge. Rotate plunger clockwise to reduce gap and counterclockwise to increase gap. Set plunger depth to hold gauge firmly when lever is in closed position. [Fig. MCT-M6]
7. Release gauge by depressing trigger. [Fig. MCT-M7]
8. Rotate plunger another 1/4 turn until slot in plunger tip is at top of tool. [Fig. MCT-M8]
9. Tighten lock nut with wrench to secure plunger and return wrench to Tool Box compartment.

The **MCT-101** tool is now calibrated for connectors on all RG-6, -59 and -11 cables.

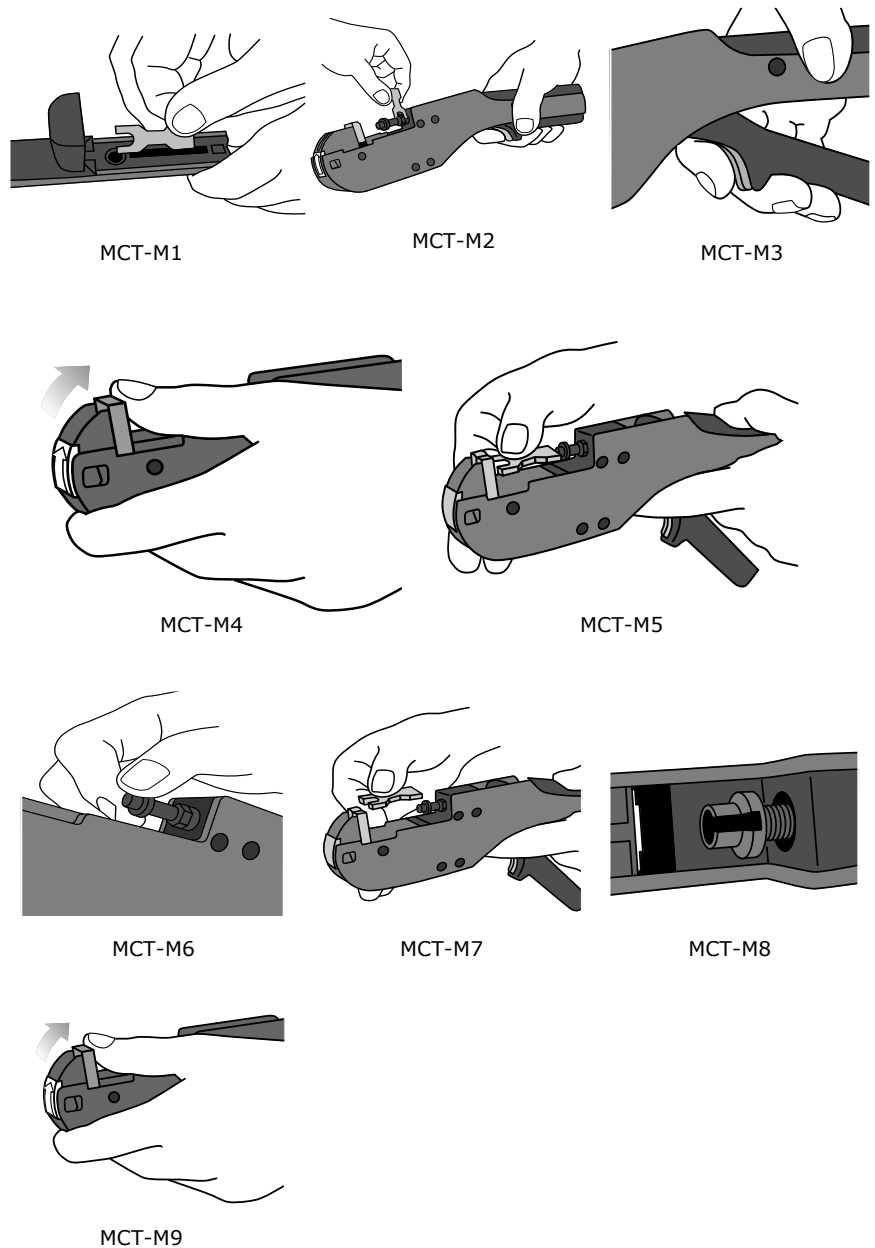

To recalibrate **MCT-102** Tools for F and RCA connectors:

1. Remove wrench from storage compartment. [Fig. MCT-M1]
2. Loosen lock nut on plunger. [Fig. MCT-M2]
3. Rotate wheel to YELLOW position. Seat spring-loaded wheel stops properly by rotating wheel slightly past position and then back to position. [Fig. MCT-M9]

Con't next page...

MCT Multi-Compression Tools Instruction Sheet

4. Note throw distance of connector by observing its slip length. [Fig. MCT-M10]
5. Close lever. [Fig. MCT-M11]
6. Place an uncompressed, unattached connector on side of plunger tip. [Fig. MCT-M12]
7. Rotate plunger so that distance from end of connector to back side of dogs is slightly more than throw distance noted in step 4. Rotate plunger clockwise to reduce gap and counterclockwise to increase gap. [Fig. MCT-M13]
8. Remove connector and rotate plunger another 1/4 turn until slot in plunger tips is at top of tool. [Fig. MCT-M8]
9. Tighten lock nut with wrench to secure plunger and return wrench to "Tool Box" compartment.

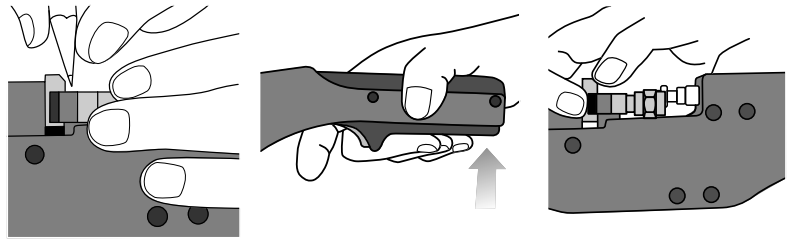

MCT-M10

MCT-M11

MCT-M12

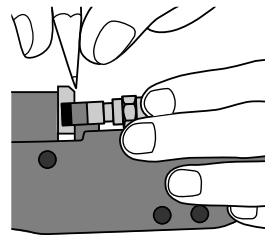

MCT-M13

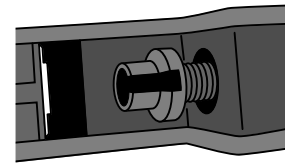

MCT-M8

To recalibrate MCT-102 Tools for BNC connectors:

NOTE: Due to the wide range of connector lengths, it may be necessary to recalibrate the tool when switching between BNC connectors.

1. Remove wrench from storage compartment. [Fig. MCT-M1]
2. Loosen lock nut on plunger. [Fig. MCT-M2]
3. Rotate wheel to RED position. Seat spring-loaded wheel stops properly by rotating wheel slightly past position and then back to position. [Fig. MCT-M9]
4. Follow steps 4 - 9 for F and RCA connectors.

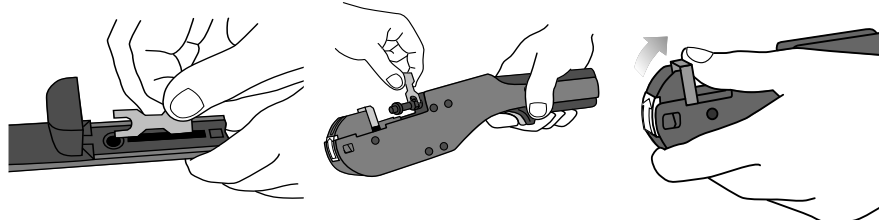

MCT-M1

MCT-M2

MCT-M9

©2008 Ben Hughes Communication Products Company.
All rights reserved.

Cable Prep, the Cable Prep logo, Tools You Trust, the Cable Prep Tools You Trust logo, the CPT logo, FOCUS, the FOCUS logo, GATOR, the GATOR logo, Super CPT, TerminX, the TerminX logo, WCPT, and Wing Ding are registered and common law trademarks of Ben Hughes Communication Products Company. All other trademarks are the property of their respective owners. Cable Prep® products and tools are covered under one or more of the following patents. U.S. Pat. Nos.: 4,729,268; 5,036,734; 5,561,903; 5,647,119; 5,749,270; 7,232,235 and other patents pending.

TECH TIP

Always keep tools free of debris and clean them regularly with BioChem Systems Cable Clear® cleaning solution, available from Cable Prep.

WARRANTY

All Cable Prep brand tools are warranted to be free from defects in workmanship and material. Plastic tool bodies have a lifetime warranty, and metal tool bodies have a limited lifetime warranty. Stripping/coring blades have a one-year warranty.



MCT Multi-Compression Tools - Ordering Information

MCT Ordering Information

MCT tools come in two configurations. Each configuration has a connector support wheel with two sets of dogs. Each set of dogs is identified by a color-coded indicator on the front of the wheel, and supports all connectors in a given class.

To determine which tool is right for your application, determine the classes of connectors that you most often use and select the tool that supports those classes. Common connectors are listed below.

Connector Support Wheel Color Key:

-  **RG-6, RG-59, and mini F and RCA**
-  **RG-11 F**
-  **RG-6, -59, and mini BNC**



Abbreviations used for MCT ordering information:



ICC - International Connectors and Cable

PPC - Production Products Company

PCT - Phoenix Communications Technology

SNS - Thomas & Betts Snap-N-Seal

		
Cablecon CX3 6 and 59 (BNC)	Yellow	Yellow
Channel Vision Push & Seal® 6, 59 and mini (F and RCA)	Yellow	Yellow
Channel Vision Push & Seal® 6, 59 and mini (BNC)		Red
Channel Vision Push & Seal® 7 & 11 (F)	Blue	
Corning Cablecon CX3 6 & 59 (F)	Yellow	Yellow
Corning Cablecon CX3 7 & 11 (F)	Blue	
Corning Gilbert GAS320QRP	Blue	
Corning Gilbert Ultra Ease® 6, 59 & mini (F and RCA)	Yellow	Yellow
Corning Gilbert Ultra Ease® 6, 59 & mini (BNC)		Red
Corning Gilbert Ultra Ease® 7 & 11 (F)	Blue	
Corning Gilbert Ultra Range® 6 & 59 (F)	Yellow	Yellow
Digicon® DS 6, 59 & mini (F and RCA)	Yellow	Yellow
Digicon® DS 6, 59 & mini (BNC)		Red
Digicon® DS 7 & 11 (F)	Blue	
F-conn FS 6, 59 & mini (F and RCA)	Yellow	Yellow
F-conn FS 6, 59 & mini (BNC)		Red
F-conn FS 7 & 11 (F)	Blue	
Holland Electronics Superlok SLC® 6, 59 and mini (F and RCA)	Yellow	Yellow
Holland Electronics	Yellow	Yellow



		
Holland Electronics Superlok SLC® 11 (F)	Blue	
ICC Push & Seal® 6 & 59 (F)	Yellow	Yellow
ICC Push & Seal® 7 & 11 (F)	Blue	
Ideal OmniCONN™ 6 & 59 (F and RCA)	Yellow	Yellow
Ideal Uniseal® 6 & 59 (F)	Yellow	Yellow
Liberty ConnecTec 6 & 59 (F and RCA)	Yellow	Yellow
Liberty ConnecTec 6 & 59 (BNC)		Red
Paladin Seal Tight® 6 & 59 (F and RCA)	Yellow	Yellow
Paladin Seal Tight® 6 & 59 (BNC)		Red
Phoenix (PCT) DRS 6 & 59 (F and RCA)	Yellow	Yellow
Phoenix (PCT) Mini 59 (F)	Yellow	Yellow
Phoenix (PCT) DRS 6 & 59 (BNC)		Red
Phoenix (PCT) DRS 7 & 11 (F)	Blue	
Phoenix (PCT) TRS 6 & 59 (F)	Yellow	Yellow
Phoenix (PCT) TRS 7 & 11 (F)	Blue	
Pico Macom Perma Seal II® 6 & 59 (F)	Yellow	Yellow
Pico Macom Perma Seal II® 7 & 11 (F)	Blue	
Pico Macom Push and Seal 6, 59 and mini (F and RCA)	Yellow	Yellow
Pico Macom Push and Seal 6, 59 and mini (BNC)		Red

MCT Multi-Compression Tools - Ordering Information

MCT Ordering Information

MCT tools come in two configurations. Each configuration has a connector support wheel with two sets of dogs. Each set of dogs is identified by a color-coded indicator on the front of the wheel, and supports all connectors in a given class.

To determine which tool is right for your application, determine the classes of connectors that you most often use and select the tool that supports those classes. Common connectors are listed below.

Connector Support Wheel Color Key:		RG-6, RG-59, and mini F and RCA
		RG-11 F
		RG-6, -59, and mini BNC



Abbreviations used for MCT ordering information:

ICC - International Connectors and Cable

PPC - Production Products Company

PCT - Phoenix Communications Technology

SNS - Thomas & Betts Snap-N-Seal

		
PPC	Yellow	Yellow
PPC	Yellow	Yellow
PPC	White	Red
PPC CMP	Yellow	Yellow
PPC	Yellow	Yellow
PPC	White	Red
PPC	Blue	White
PPC	Blue	White
Steren	Yellow	Yellow
Steren	White	Red
Steren	Blue	White
Stirling	Yellow	Yellow
Stirling	Blue	White
Stirling	Yellow	Yellow
Stirling	White	Red
Stirling	Blue	White
Thomas & Betts	Yellow	Yellow
Thomas & Betts	White	Red